

LED DOCK LIGHTS

PQ-DLG1 and 2

Our dock lights provide light into trailers during the loading and unloading process with a high-visibility beam of light attached to an adjustable arm. This light creates a productive, safe working environment. Illuminates trailers with bright, long-lasting, and energy-efficient lighting on a heavy-duty design, made for applications that are susceptible to wear and damage. They deliver lower energy cost with high quality superior light over incandescent, quartz or metal halide technologies traditionally used in loading dock applications.

- Optimum brightness for entire length of trailer.
- Built-in switch to control on-off.
- Adjustable screw on the lamp allows adjustment of lamp angle by hand.
- Eliminates light bulb replacement and/or cleanup.
- Compact design utilizes aluminum housing for cooling system.
- High-visibility beam angles optional.
- Cree LED is available.



SPECIFICATIONS FOR PQ-DLG1

Input Voltage	AC100-277V – 50-60 Hz
CCT	3000K/4000K/5000K/5700K/6500K
LED brand	CREE
Power factor	≥ 0.9
IP rating	IP65
CRI	>70

XX= Color temperature : 31K=3000K-3500K 41K=4000K-4500K 51K=5000-5500K 61K=6000-6500K

MODEL	WATTAGE	TOTAL LUMENS	DIMENSIONS	BEAM ANGLE
PQ-DLG1-20W	20W	2200LM ± 10%	φ 177 x 115.8 mm	20°/30°/110°
PQ-DLG1-30W	30W	3300LM ± 10%		
PQ-DLG1-50W	50W	5500LM ± 10%	φ 240 x 118.5 mm	30°/80°/110°
PQ-DLG1-60W	60W	6600LM ± 10%		

DIMENSIONS

Unit: inch/mm

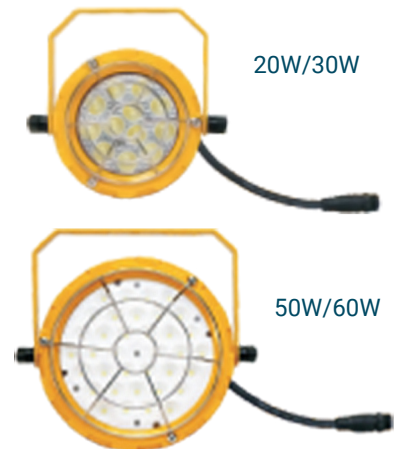
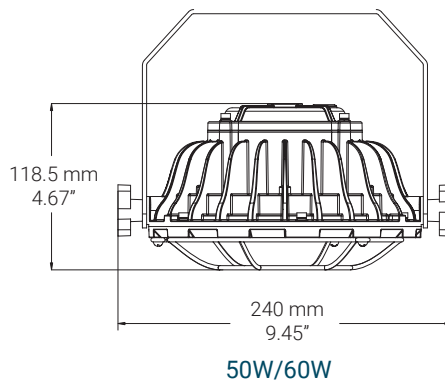
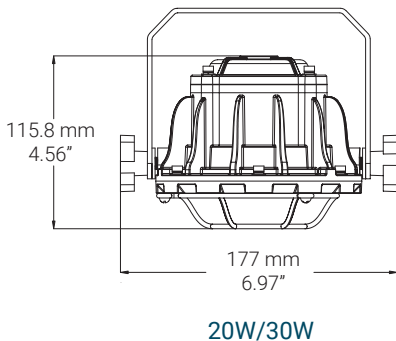

LED DOCK LIGHTS

PQ-DLG1 AND PQ-DLG2

PQ-DLG1



20W/30W – BRACKET A

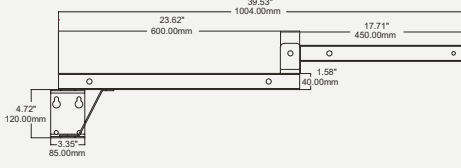
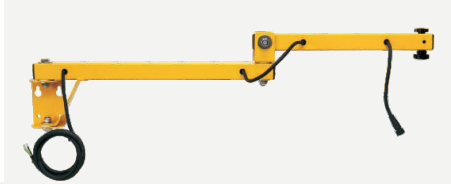

50W/60W – BRACKET B

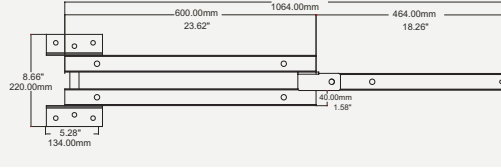

1. Branded LEDs
Cree LEDs are available, LM80 report, long lifetime



20° / 30° / 110°



30° / 80° / 110°

2. Beam angles
High-visibility beam angles with these options:
20W/30W: 20°/30°/110°
50W/60W: 30°/80°/110°



3. Aluminum Housing
Diecast aluminum housing for maximum heat dissipation



4. Rear switch button
Built-in switch to control on-off state



5. Stainless steel cage
Good protection for the lamp, anticorrosion and durable.



6. Electrical outlet
Comes with regular waterproof connector



7. Cord
Comes with 5 ft (1.5 m) cord.



8. Adjustable screw
Can be adjusted for different lighting directions.

LED DOCK LIGHTS

PQ-DLG1 AND PQ-DLG2

PQ-DLG2



SPECIFICATIONS FOR PQ-DLG2

Input Voltage	AC100-277V – 50-60 Hz
CCT	3000K/4000K/5000K/5700K/6500K
LED brand	CREE
Power factor	≥ 0.9
IP rating	IP65
Dimension	219 x 163 x 70 mm
Beam angle	30°
CRI	>70

XX= Color temperature : 31K=3000K-3500K 41K=4000K-4500K 51K=5000-5500K 61K=6000-6500K

MODEL	WATTAGE	TOTAL LUMENS
PQ-DLG2-20W	20W	2800LM ± 10%
PQ-DLG2-30W	30W	4200LM ± 10%
PQ-DLG2-40W	40W	5600LM ± 10%
PQ-DLG2-50W	50W	7000LM ± 10%

- Using CREE LEDs, high lumens up to 140 LPW
- Safety yellow rugged cast aluminum housing
- Comes with an on-off switch on the light head for easy operation
- High light transmittance PC cover
- Anti-corrosion stainless steel cage with good impact resistance
- High reliable constant current LED driver
- Available with multiple optional swing brackets

DIMENSIONS

Unit: inch/mm

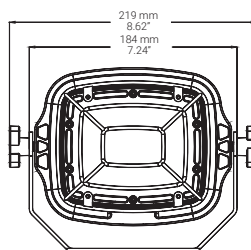
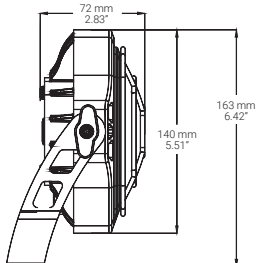

20W/30W/40W/50W

LED DOCK LIGHTS

PQ-DLG1 AND PQ-DLG2

PQ-DLG2



SINGLE ARM



DOUBLE ARM



ARM WITH RECEPTACLES

Cord length of bracket is 5 ft (1500 mm),
120V US grounded plug optional

Single Arm

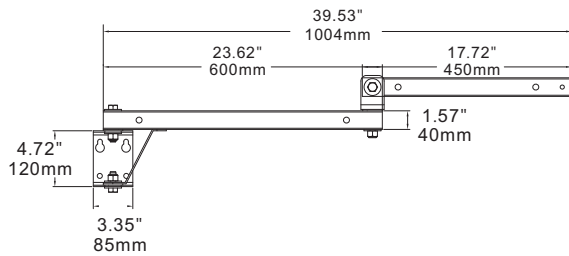

40" Bracket A1

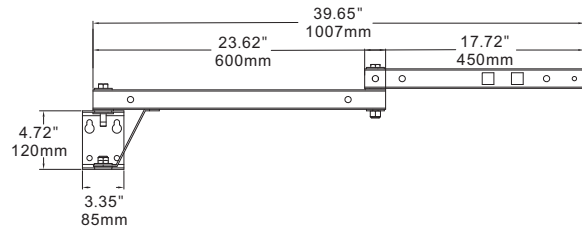

40" Bracket A2, built-in receptacle

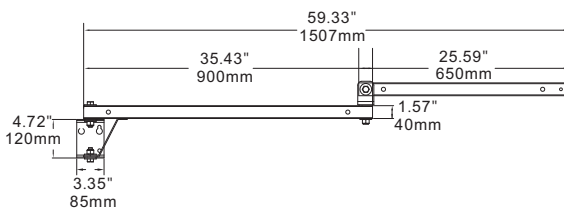

60" Bracket A3

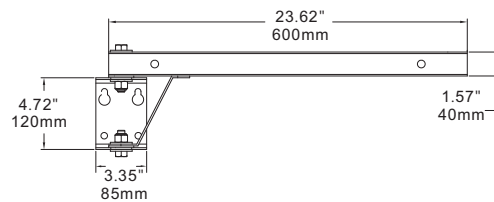

24" Bracket A4

LED DOCK LIGHTS

PQ-DLG1 AND PQ-DLG2

PQ-DLG2

Double Arm

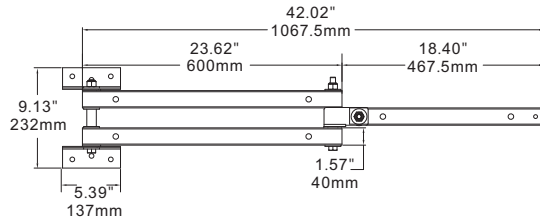

40" Bracket B1

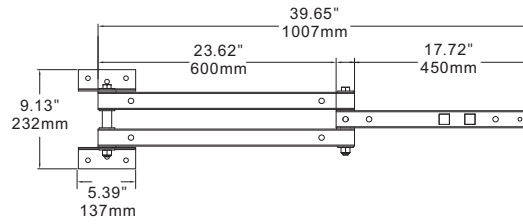

40" Bracket B2, built-in receptacle

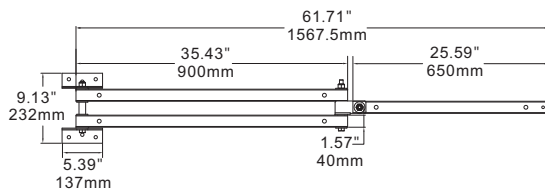

60" Bracket B3

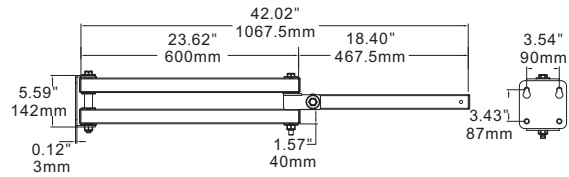

40" Bracket C1

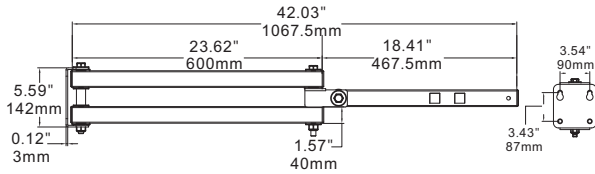

40" Bracket C2, built-in receptacle

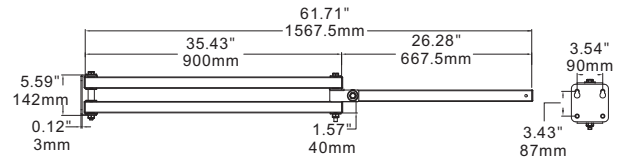

60" Bracket C3

LED DOCK LIGHTS

PQ-DLG1 AND PQ-DLG2

PQ-DLG2

1. Lumens up to 140LPW

Using a Cree LED, lamp has a higher junction temperature, extended lifetime and lower light degradation.

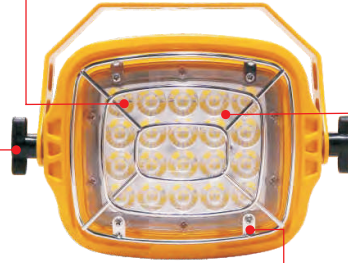

2. 30° PC lens

Long reach spot lighting suitable to light up the full length of truck trailers.

4. Hand-twistable screw

Allows light to be directed at different angles.



3. Stainless steel cage

Durable design with good impact resistance, anti-corrosion



5. Safety yellow aluminum housing

Diecast aluminum housing with fin design for excellent cooling effect

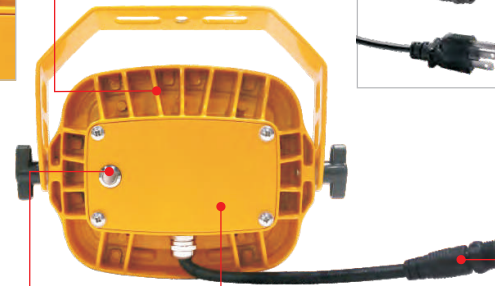

6. Connector design

Supplied with 1 ft (300 mm) regular waterproof connector. 120V grounded US plug is optional.



7. On/Off switch

Built-in switch to control on-off state, easy operation



8. OEM label service offered

Customized label design can be lasered onto the back panel of the lamp.

