

CLEAN BAY

PQ-HBCD

SAFETY PRECAUTIONS

To reduce the risk of death, personal injury, or property damage from fire, electric shock, falling parts, cuts/abrasions, and other hazards, read all warnings and inspect the box and all labels on the lighting fixture.

Before installing, servicing, or performing maintenance on this equipment, follow these general precautions. Commercial installation, service, and maintenance of luminaires should be performed by a qualified licensed electrician.

For installation

If you are unsure about the installation or maintenance of the luminaires, consult a qualified licensed electrician and check the local electrical code.

To prevent wiring damage or abrasion, do not expose the wiring to the edges of sheet metal or other sharp objects. Do not make or alter any openings in an enclosure of wiring or electrical components during kit installation

WARNING: FIRE OR ELECTRICAL SHOCK HAZARD

Turn off electrical power at the fuse box or circuit breaker before wiring the lighting fixture to the power supply. Turn off the power during any maintenance operation. Verify that the supply voltage is correct by comparing it with the information on the luminaire label. Make all electrical and grounding connections in accordance with the National Code and any applicable local code requirements. All wiring must be capped with UL-approved wire connectors.

CAUTION: RISK OF INJURY

Avoid direct exposure of the eyes to the light source when it is on. Be mindful of small parts and dispose of packaging material, as they may be hazardous to children.

HOOK INSTALLATION

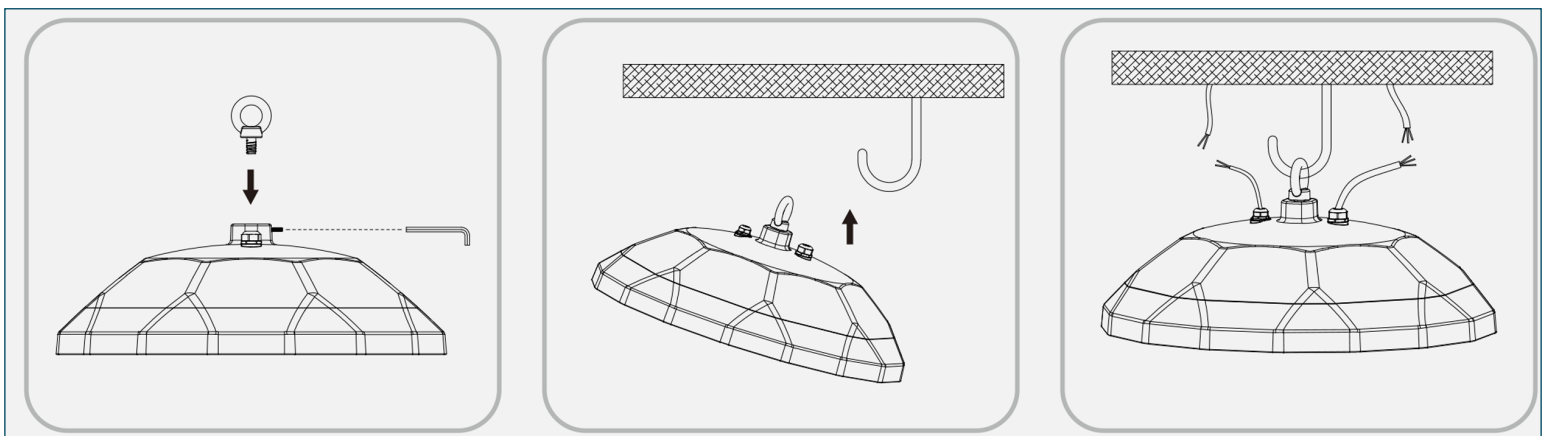

1. Fix the ring to the lamp (rotate clockwise), tighten the screw.

2. Put the ring into the mounting hook.

3. Wired as required under safety protection.

CLEAN BAY

PQ-HBCD

PENDANT INSTALLATION

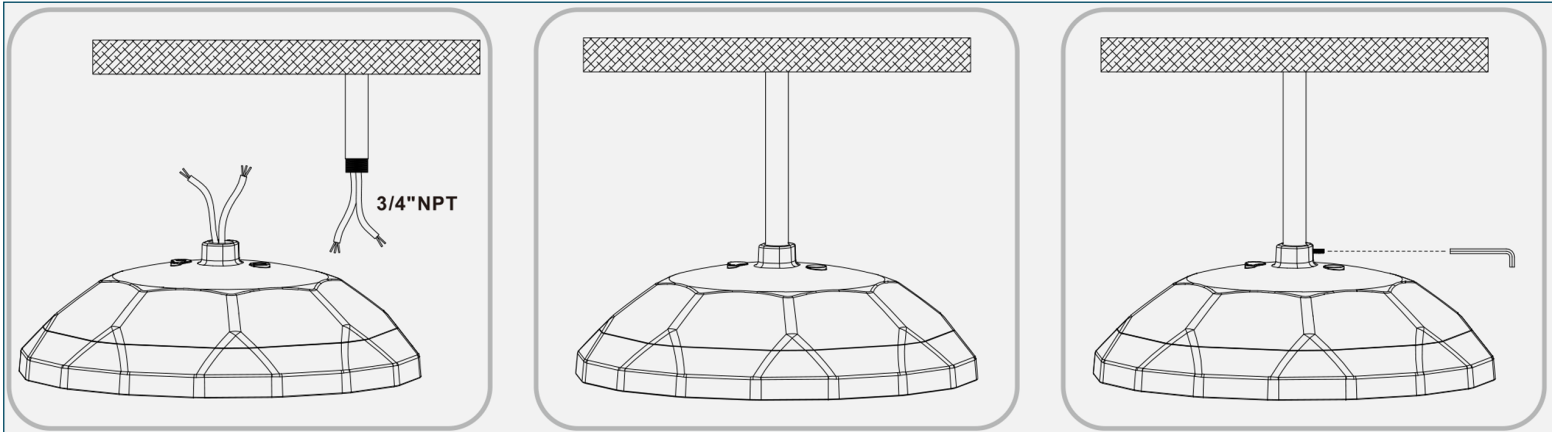

1. Wired as required under safety protection.

2. Rotate the lamp to the mounting pipe (rotate clockwise).

3. Tighten the screw.

PENDANT WITH JUNCTION BOX INSTALLATION

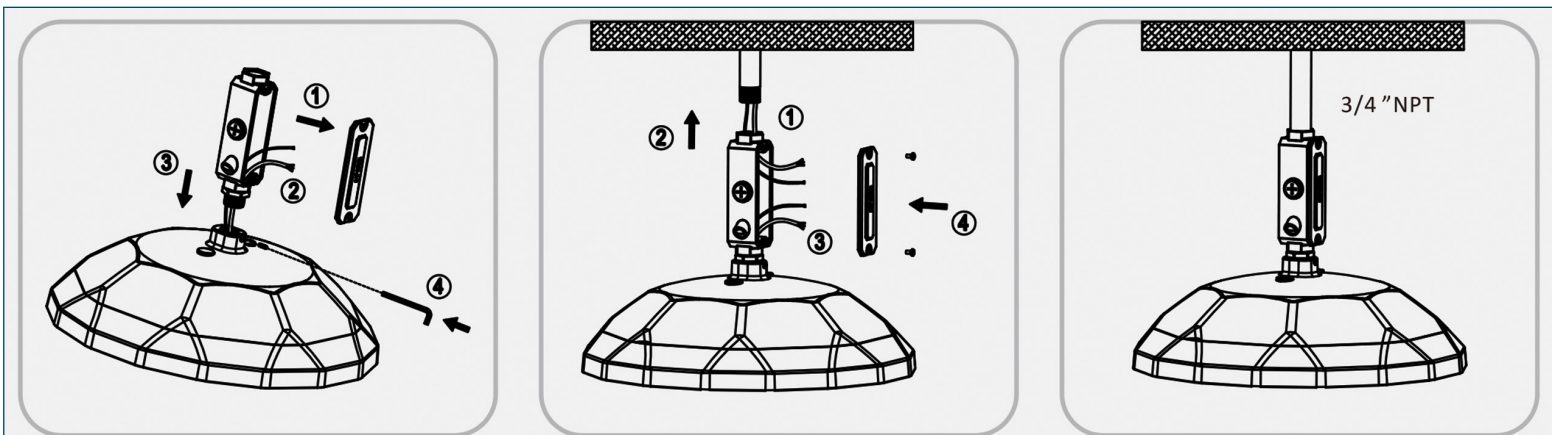

1. Remove the cover, thread the wire into the junction box, and tighten the terminal box and set screw.

2. Thread the wire into the junction box, install the junction box on the pipe, wire according to the requirements, take protective measures, and lock the cover.

3. Installation effect.