

# LIGHTING LINEAR DEL

PQ-LIE



## WARNING

- This product must be installed in accordance with the applicable installation code by a person familiar with the construction and operation of the product, as well as associated risks.
- Risk of fire or electric shock. Installing the LED lamp requires knowledge of luminaire electrical systems. If you are not qualified, do not attempt installation. Contact a qualified electrician.
- For use only in dry locations.
- This lamp supports dimming function and should be used with dimmers.
- Minor noises when shaken do not affect quality.
- Surface or suspension mounting option.

## THE ACCESSORY BAG INCLUDES:

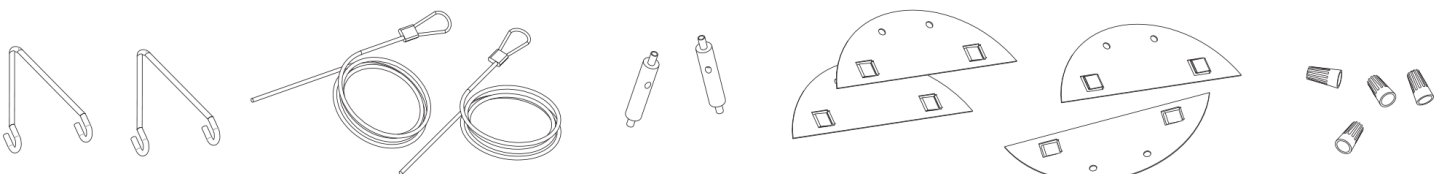

# LIGHTING LINEAR DEL

PQ-LIE

## ASSEMBLY INSTRUCTIONS

### A. SURFACE INSTALLATION

Choose any two of the following surface installation methods according to your needs

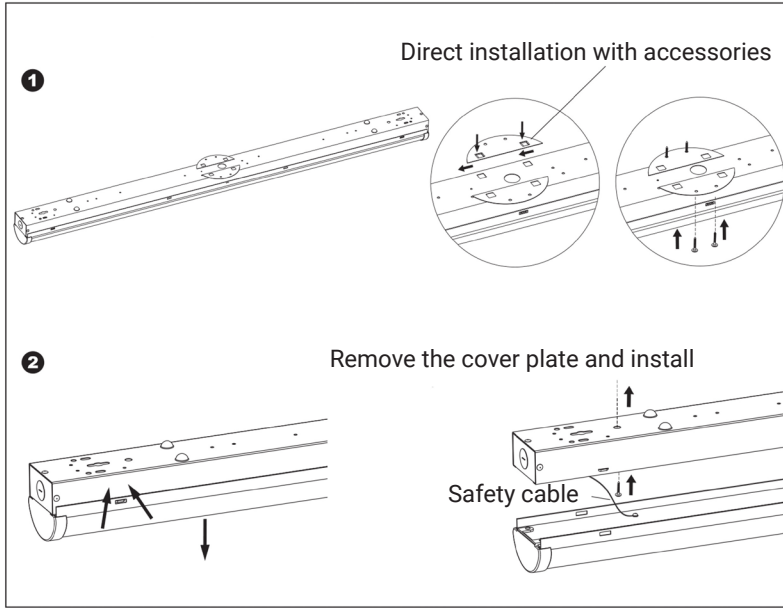

### B. SUSPENSION INSTALLATION

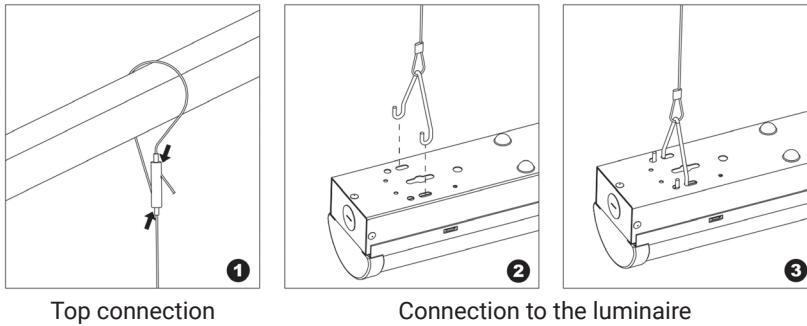

### C. CONNECTION INSTALLATION

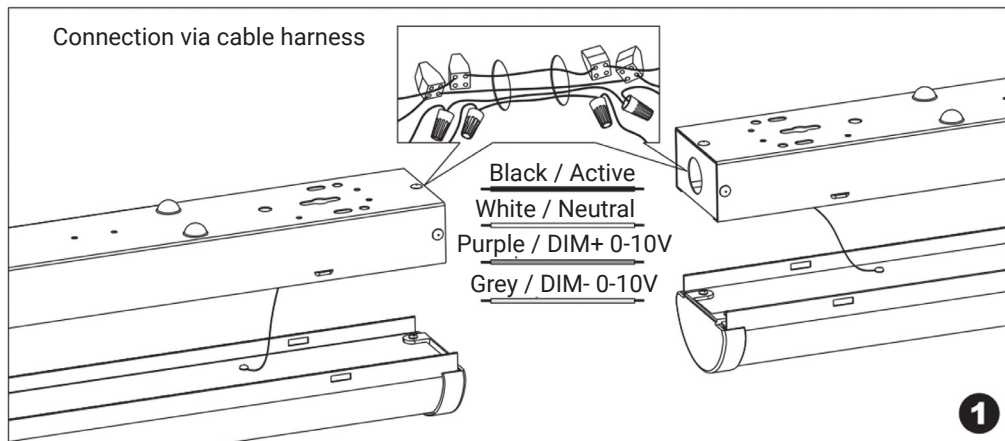

# LIGHTING LINEAR DEL

PQ-LIE

## C. CONNECTION INSTALLATION

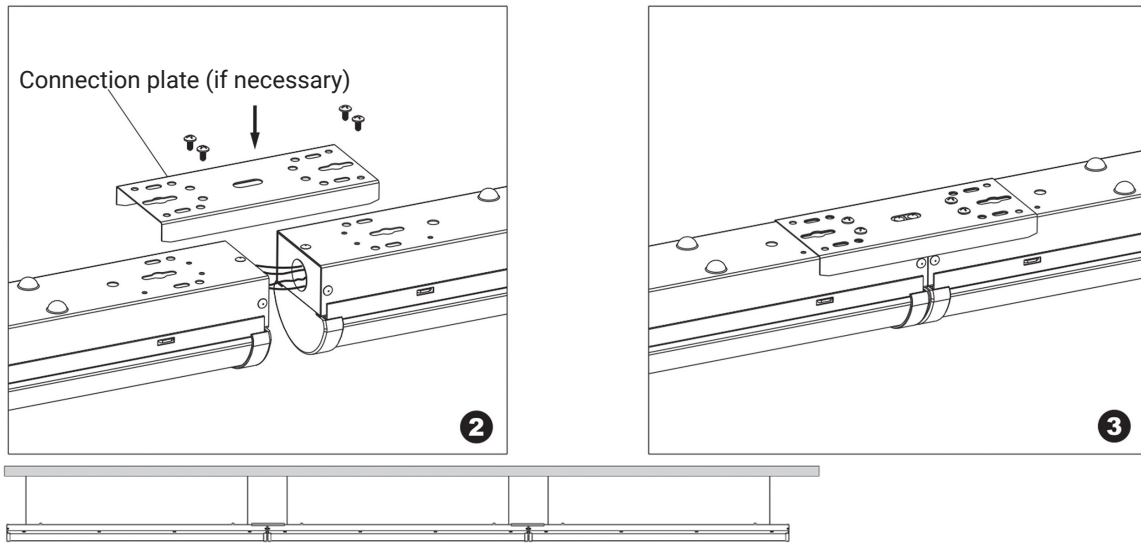

Note :

For safety reasons, please do not connect more than 4 4-foot LED fixtures in line; do not connect more than 3 8-foot LED fixtures in line.

## D. OPERATING GUIDE

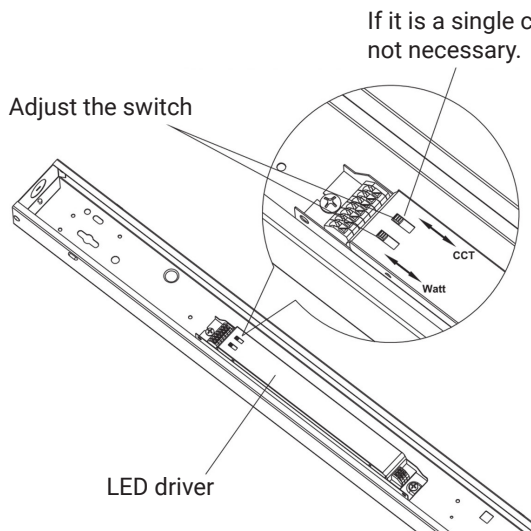
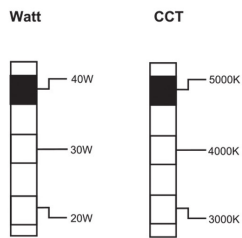

Adjust the switch and set it to the required power and color temperature.

Note :  
Due to different models of LED drivers, specific functions of the switch depend on the actual label on the switch provided with the LED driver.

### Wiring guide

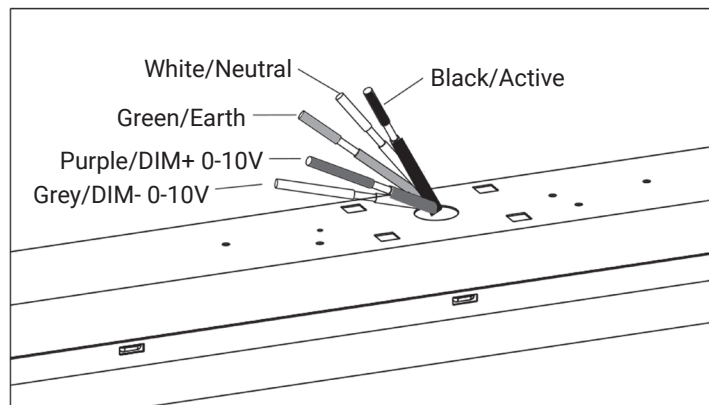

# LIGHTING LINEAR DEL

PQ-LIE

## SENSOR INSTALLATION

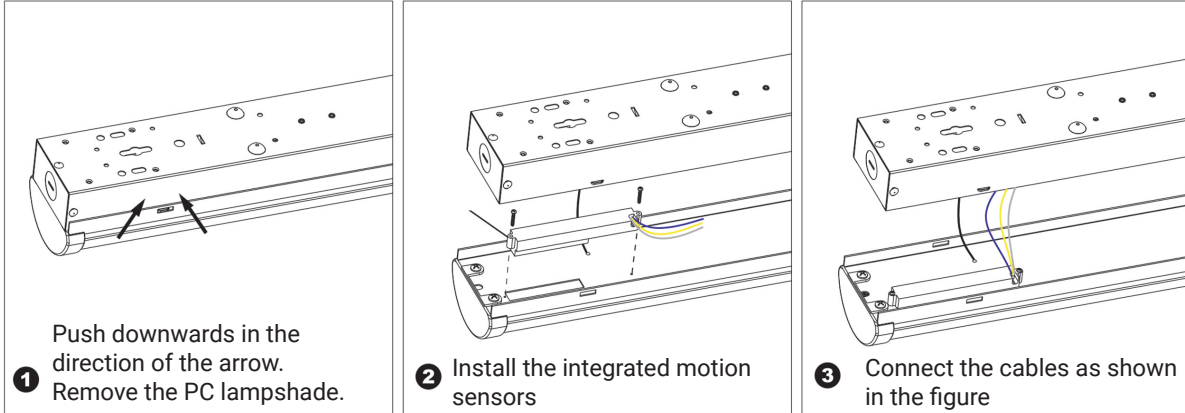

## WIRING DIAGRAMS

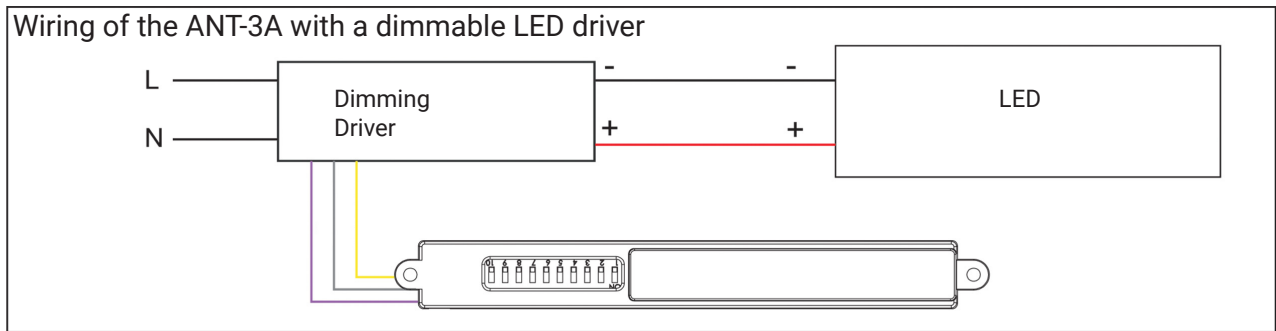

## INFORMATION ABOUT THE INTEGRATED MOTION SENSOR

ANT-3A

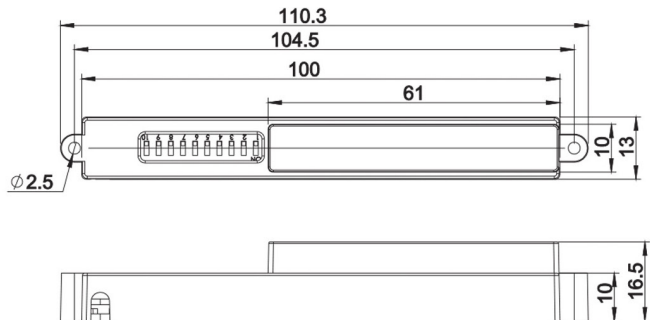
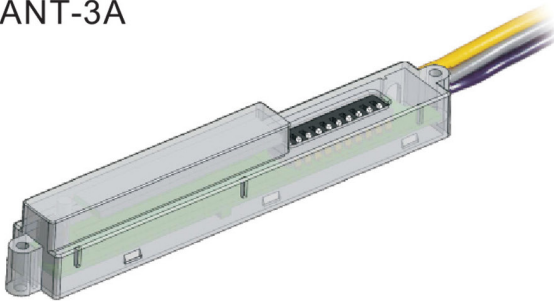

NOTE: The preheating time is 15 seconds. After the sensor connects to power for the first time, the light will stay on for 15 seconds, then enter dimming mode to operate normally.  
 NOTE: Factory default settings: Sensitivity at 100%, Hold Time: 10 seconds, Natural Light Sensor at 30 lux, Dimming Level: 30%, Dimming Time: 60 minutes.  
 NOTE: Any setting changed by a DIP switch or remote control will cause the connected LED light to turn on/off as confirmation.

### SETTING PARAMETERS BY DIP SWITCH

Refer to the image: 1, 2 adjust sensitivity; 3, 4 adjust hold time; 5, 6 adjust lux brightness level; 7, 8 adjust standby light level; 9, 10 adjust standby time.



### SPECIFICATIONS

Power Supply	12V-24V DC, >50mA
RF System	5.8GHz $\pm$ 75MHz
Dimming Control Output	0-10V, Maximum latching current of 25 mA
Detection radius/angle	Maximum 17 feet (5.2 meters) / 360 degrees
Mounting height	Maximum 13 feet (4 meters)
Remote control range	50 feet (15 meters) indoors, without backlight
Humidity	Max. 95% relative humidity
Temperature	-40°F to 158°F (-40°C to 70°C)

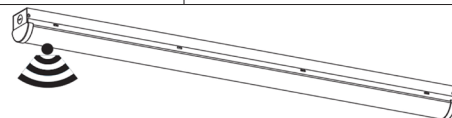

# LIGHTING LINEAR DEL

PQ-LIE

## EMERGENCY LED DRIVER INSTALLATION

### EMERGENCY LED DRIVER INSTALLATION POSITION

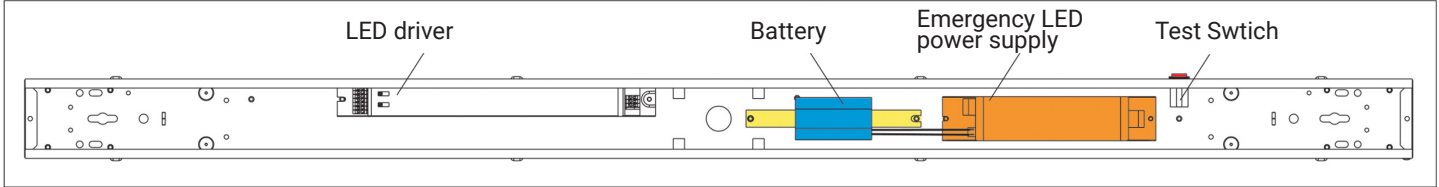

### WIRING DIAGRAMS

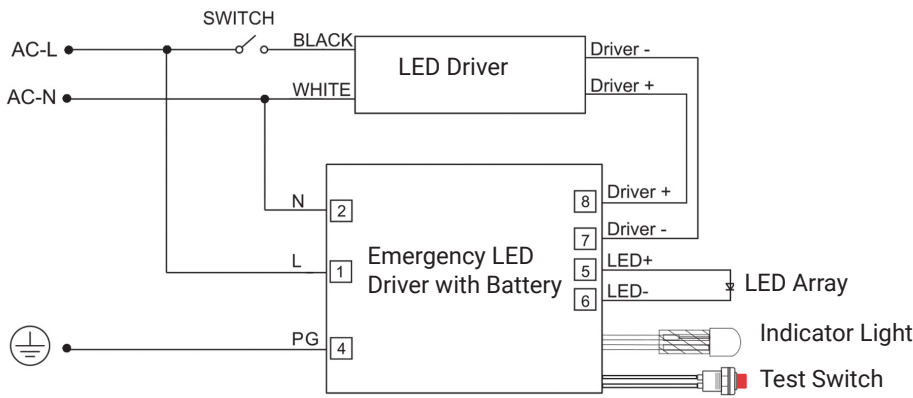

### EMERGENCY LED DRIVER INFORMATION

#### SPECIFICATIONS



Universal input voltage	100-277Vac, 50-60Hz
AC input current	100 mA max.
Nominal AC input power	7.0 W max.
Output current and voltage	60-320 mA, 25 48Vdc
Output power	8W
Emergency time	≥ 1.5 hour
Warranty	5 years
Test switch with indicator light	Test switch with light indicator, pilot light
Battery	Battery Li-ion 7.4V/2500mAh
Battery charging current	250mA
Charging time: 24 hours	≥ 24 heures
Temperature rating (ambient)	Li-ion 0 °C to +40 °C (32°F to 104w°F)

#### DIMENSIONS:

Enclosure - 7.4" x 1.5" x 1.14" (mounting center - 7.0")  
 Battery - 6.1" x 1.57" (mounting center - 5.66")

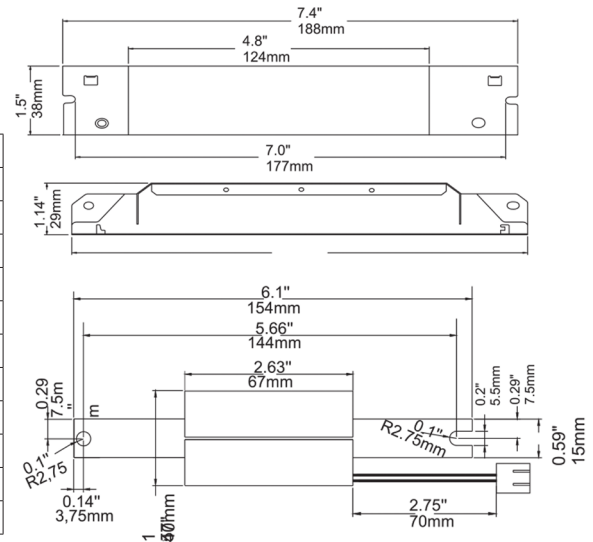

#### Operation in Alternating Current (AC)

When AC power is present, the LED load from the LED driver is powered normally. The output current of the LED driver in AC must not exceed 150 W or 4 A. The emergency driver is in standby and charging mode. The green LED indicator light comes on to indicate it is charging.

#### Operation in Emergency Mode

In the event of AC power failure, the emergency driver detects the AC power loss and automatically switches to operational emergency mode. The green LED indicator light goes out. When AC power is restored, the emergency driver returns to normal operation mode with AC power and begins recharging. The green LED indicator light comes on.